

# HEBEFIX

## ABOVE-FLOOR TANK

The Hebefix above-floor tank is the ideal solution where there is no wastewater pipe available to dispose of dirty water from a bathroom (excl. toilet waste), laundry or kitchen. Combined with Jung Pumpen U3KS, U3KS special or a U5KS, greywater can be collected and disposed of easily and efficiently.



### KEY FEATURES

- Option of pairing with Jung Pumpen U3KS, U3KS special or U5KS to match application requirement
- Pre-stamped cut outs for easy installation
- Easy access cover without dismantling pipework

Introducing

 **PENTAIR JUNG PUMPEN**

# HEBEFIX

## ABOVE-FLOOR TANK

### THE BEST SOLUTION TO DISCHARGING WASTEWATER WHERE THERE IS NO DIRECT ACCESS TO THE MAIN SEWAGE PIPE

The Hebefix offers an ideal solution to store and automatically pump greywater to the sewer line where there is no existing waste water pipe. The Hebefix can be paired with one of three Jung Pumpen pumps to suit most domestic applications for convenient grey water disposal.



### FEATURES

- Compact design with easy-to-clean surfaces
- 4 inlet sleeves for disposal of wastewater from basin, shower, bathtub, kitchen sink, dishwasher, laundry trough or washing machine
- Pre-stamped cut outs for easy installation
- Entry points on both sides and top
- Option of pairing with Jung Pumpen U3KS, U3KS special or U5KS to match application
- Easy access cover without dismantling a pipe work
- Ventilation valve with activated carbon filter
- Installation accessories kit with swing-type check valve and activated carbon filter included
- Wall or floor mount installation



### ADVANTAGES OF OUR TANK DESIGN

- Quality cover seal
- Easy-to-open cover
- Large capacity carbon filter allows for use up to 1 year
- Convenient integration with Jung Pumpen U3KS, U3KS Special and U5KS pumps

### Inside view of lid

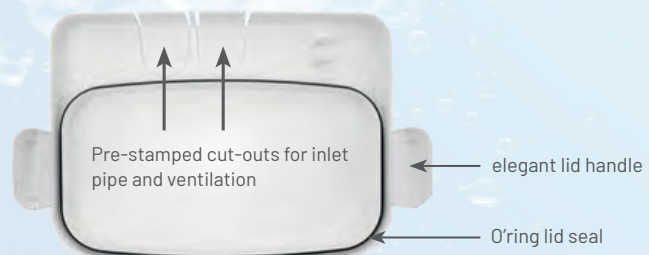

*Innovative pre-stamped cut-outs allow the cover to be easily taken off without removing any pipe connection making it quick and easy to maintain and service.*

**NEW  
PRODUCT**



**APPLICATIONS**

KITCHEN	BATHROOM	LAUNDRY
<ul style="list-style-type: none"> <li>• kitchen sink</li> <li>• dishwasher</li> <li>• coffee machine grinds</li> <li>• outdoor BBQ kitchen</li> </ul>	<ul style="list-style-type: none"> <li>• hand basin</li> <li>• shower</li> <li>• bath</li> </ul>	<ul style="list-style-type: none"> <li>• laundry trough</li> <li>• washing machine</li> </ul>

**RECOMMENDED PUMPS**

U3KS	U3KS SPECIAL	U5KS
 <p>U3 KS JP50024</p> <ul style="list-style-type: none"> <li>• Greywater including domestic dishwashers and washing machines</li> <li>• Flows &lt;100 l/min</li> <li>• Liquid temperatures &lt;35° C, temporarily &lt;60° C (&lt;10 min)</li> </ul>	 <p>U3 KS special JP50023</p> <ul style="list-style-type: none"> <li>• Greywater including domestic dishwashers and washing machines</li> <li>• Saline solutions up to 15% including brine from water softeners</li> <li>• Condensate from boilers, whey liquid and liquid fertilisers</li> <li>• Flows &lt;100 l/min</li> <li>• Liquid temperatures &lt;35° C, temporarily &lt;60° C (&lt;10 min)</li> </ul>	 <p>U5 KS JP44091</p> <ul style="list-style-type: none"> <li>• Greywater including domestic dishwashers and washing machines</li> <li>• Flows &lt;180 l/min</li> <li>• Liquid temperatures &lt;35° C</li> </ul>

**EXAMPLE OF INSTALLATION**

**• Floor mounted**

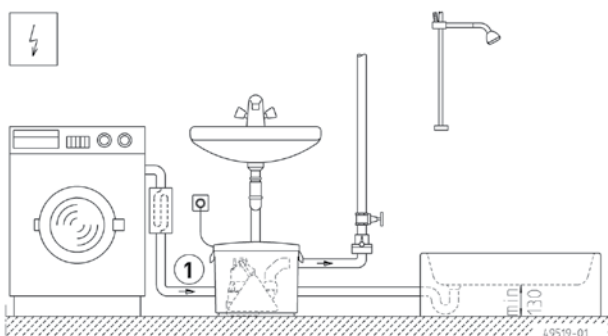

**• Wall mounted**

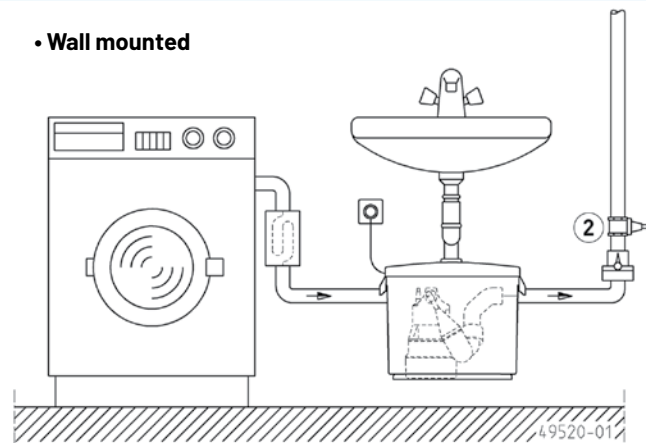

## SCOPE OF SUPPLY

Plastic tank (ABS), without pump, with integrated connection hose, clamps, swing-type check valve R32, activated carbon filter, rubber feet and other installations accessories. The unit is in conformity with WaterMark standards.

## MECHANICAL DATA

Tank Capacity	Weight
26 l	3.2 kg

## HEBEFIX

Type	Code No.
Hebefix	<b>JP50210</b>

## PERFORMANCE

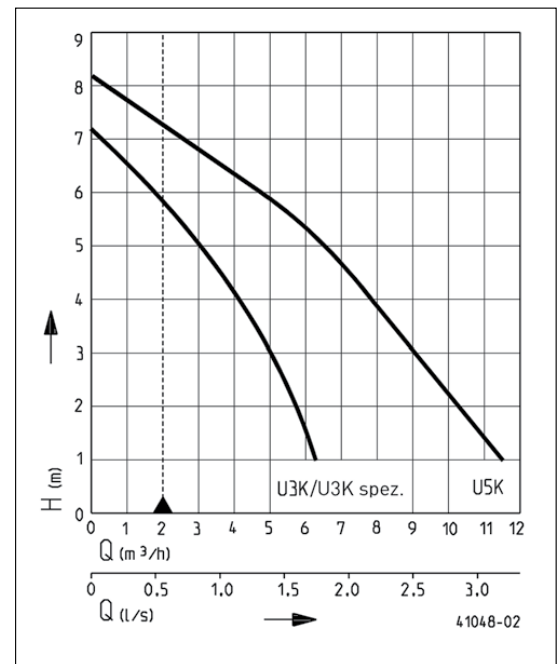

## MECHANICAL ACCESSORY



① Special float

for lower switching points (U3 only)

Code No

**JP44795**

## DIMENSIONS

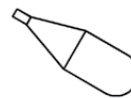
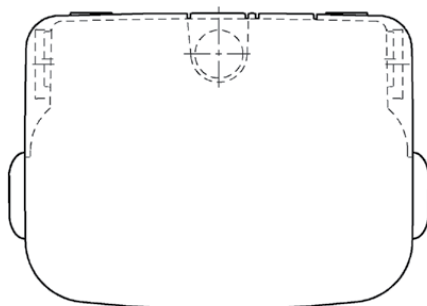
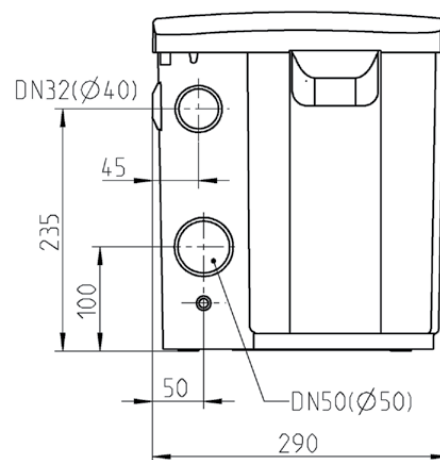
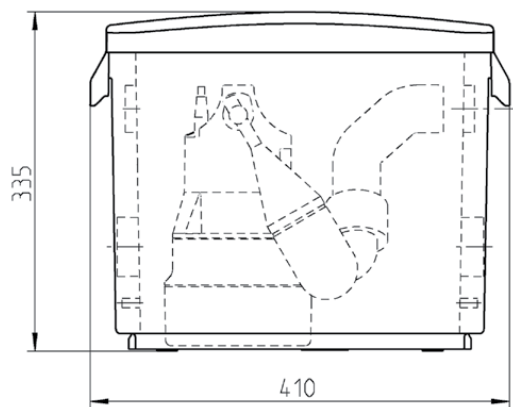

	ON	OFF
U3	220	110
U5	245	140

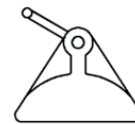

	ON	OFF
U3	110	50



1-21 Monash Drive | Dandenong South, VIC 3175 | Australia | 1300 137 344 | pentair.com.au

Information contained here-in remains the property of Pentair under Australian copyright law. Content may not be reproduced or transmitted without our prior written permission.

© 2023 Pentair. All rights reserved. This document is subject to change without notice.