

U6 KS

DRAINAGE PUMP



- Cooling jacket for motor housing
- Flushing device
- Low level pumping by detachable strainer base
- SiC mechanical seal independent of sense of rotation
- Run dry protection
- 10/20 mm free passage with EIP technology
- Replaceable moisture sealed cable inlet
- Fluid temperature 35 °C

DESCRIPTION

The U6 K range of pumps is suitable for stationary and portable use.

It can be used as a drainage pump for mildly contaminated waste and ground water, in sumps with rain water, drainage or seepage water, silage liquor and liquid manure. The high quality mechanical seal also makes the pump suitable for extracting abrasive media.

In stationary use the U6 K ES/DS removes the wastewater from domestic appliances such as dishwashers and washing machines. Guide rail systems offer the advantages of quick and easy maintenance. If the sump or tank runs dry temporarily, the pump is vented via an opening in the discharge elbow.

For supporting sewage water with heavy pollution, we recommend our US series.

PERFORMANCE

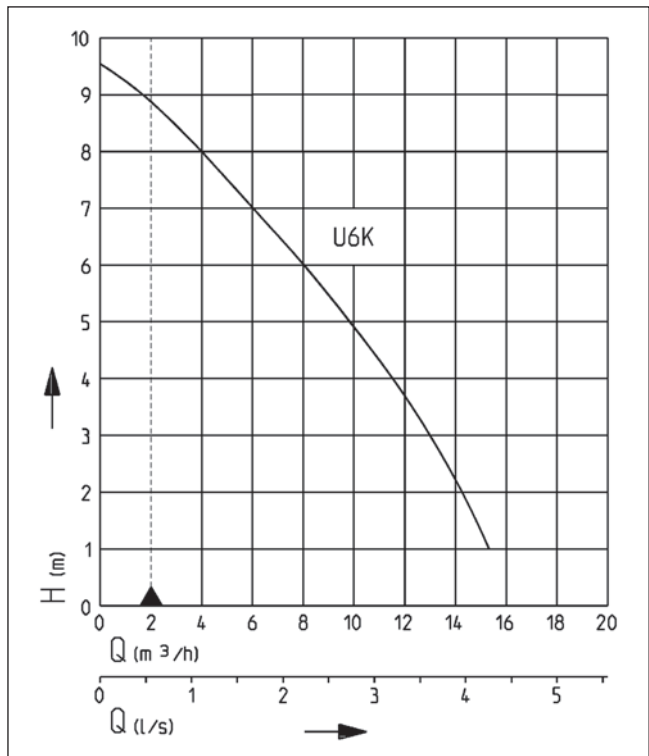

Type	Delivery head H [m]	1	2	3	4	5	6	7	8	9
U6 K ES/DS	Flow rate Q [m³/h]	15.5	14.5	13.0	11.5	9.5	8.0	6.0	4.0	1.5

Specifications can be changed without notice. Performance subject to ISO 9906 tolerances. This data is represented in the performance curve as a limit of application.

U6 KS

DRAINAGE PUMP

SCOPE OF SUPPLY

Pump ready for connection with 90° 1/4" female connection elbow, cable and plug, with automatic level float switch. The pump is delivered with attached strainer base, which can be exchanged for the enclosed feet if 20 mm free passage is required.

MECHANICAL DATA

Pump	Vertical single-stage
Free passage	20 mm
Bearing	Ball bearings, grease-lubricated
Seal on motor side	Rotary shaft seal
Oil chamber	Yes
Seal on medium side	SiC mechanical seal

Run dry protection	Yes
Shaft	Stainless steel
Impeller	Vortex impeller, GFK
Motor housing	Stainless steel
Submersible	Yes
Pressure outlet	1 1/4" MI

ELECTRICAL DATA

Motor rating P1	0.75 kW
Type of enclosure	IP 68
Insulation class	B

Winding thermostat	Yes
Motor protection	Integrated

U6

Type	Code No.	Voltage	Motor rating P2	Current	Power line	Wires	Plug	Weight
With built-in level control								
U6K ES, 10 m cable	JP44085	1/N/PE~230 V	0.50 kW	3.3 A	10m H07RN-F	3G1,0	ANZ	6.2 kg
U6K DS, 10 m cable	JP09261	3/PE~400 V	0.55 kW	1.3 A	10m H07RN-F	4G1,0	CEE	6.8 kg

U6 KS

DRAINAGE PUMP

Dimensions and switching points U6 KS (mm)

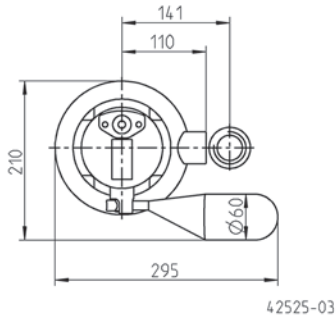
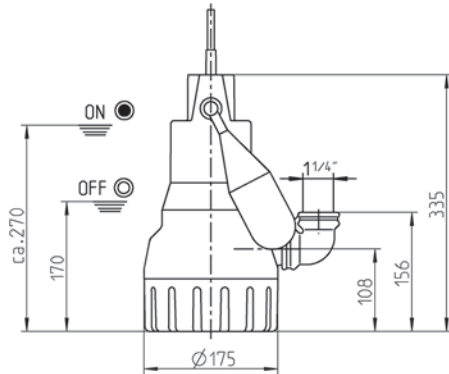

Dimensions and switching points special float (mm)

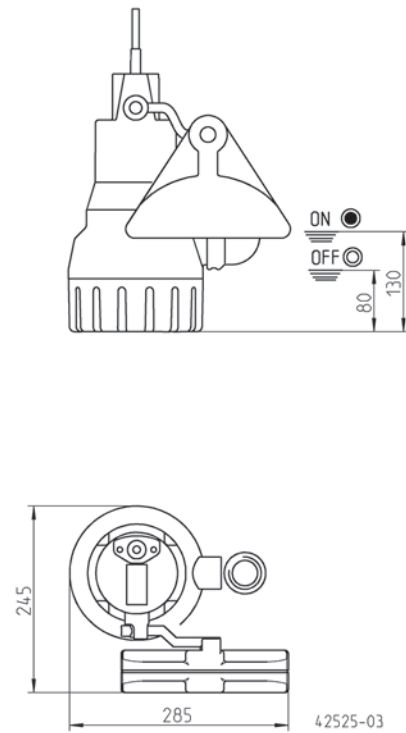

Dimensions and switching points special float (mm)

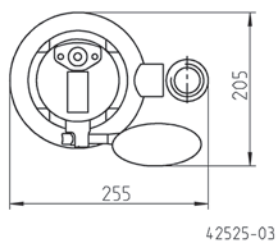
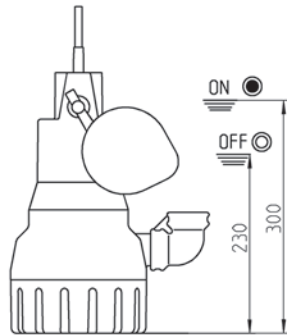

Dimensions and switching points GR 32 (mm)

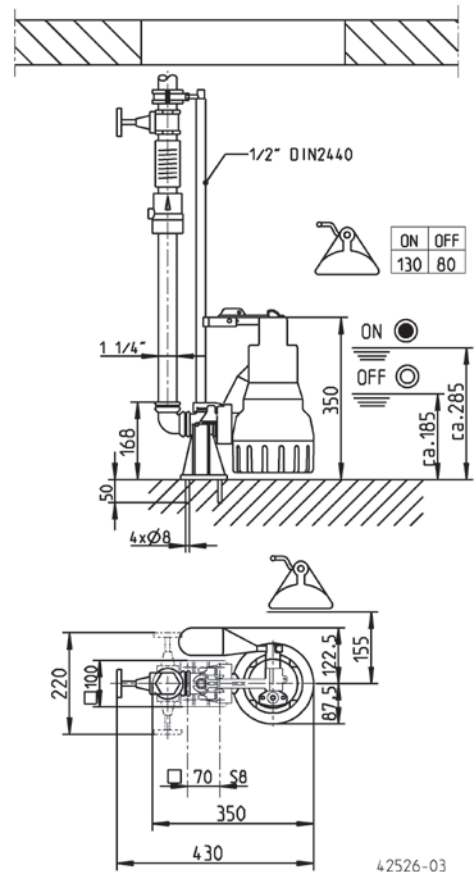

U6 KS

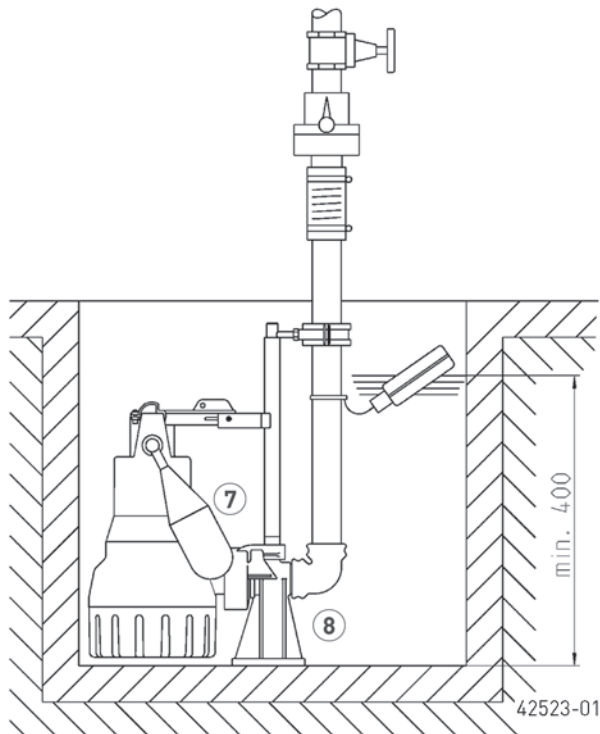

DRAINAGE PUMP

Example of single pump installation with GR



Single unit with GR: sump area min. 40x50 cm or Ø 50 cm
 Single unit without GR: sump area min. 40x40 cm or Ø 40 cm

MECHANICAL ACCESSORY

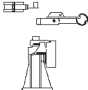
			Code No.
	7 Special float	for lower switching points (U5 and U6)	JP44207
		for narrow chambers (mind. 30x30 od Ø30 cm)	JP40856
	Float fixation	for continuous pump operation	JP42175
	8 Guide rail system	GR 32	JP44000