

US 73-US 103

SUBMERSIBLE DRAINAGE PUMP

- 30 mm free passage
- Run dry protection
- Controllable oil chamber
- SiC mechanical seal
- Replaceable moisture sealed cable inlet
- Fluid temperature 40 °C



DESCRIPTION

The centrifugal submersible drainage pumps US 73-103 are suitable for dealing with contaminated water and capable of handling solids up to 30 mm particle size without stones. Fibrous waste water, as found in laundries or automatic laundrettes and waste water from domestic dishwashers and washing machines can be handled by this pump range. For hot water in the industrial and commercial market we recommend the US 73 and US 103 HE/HES.

This range of pumps is suitable for stationary use. For easy removal of the pumps from deep sumps we recommend the use of our guide rail systems which provide ease of maintenance and inspection.

The cable length is 10 m.

The sewage pumps are tested by the German Institute for Construction Engineering and correspond to the valid construction and test principles.

PERFORMANCE

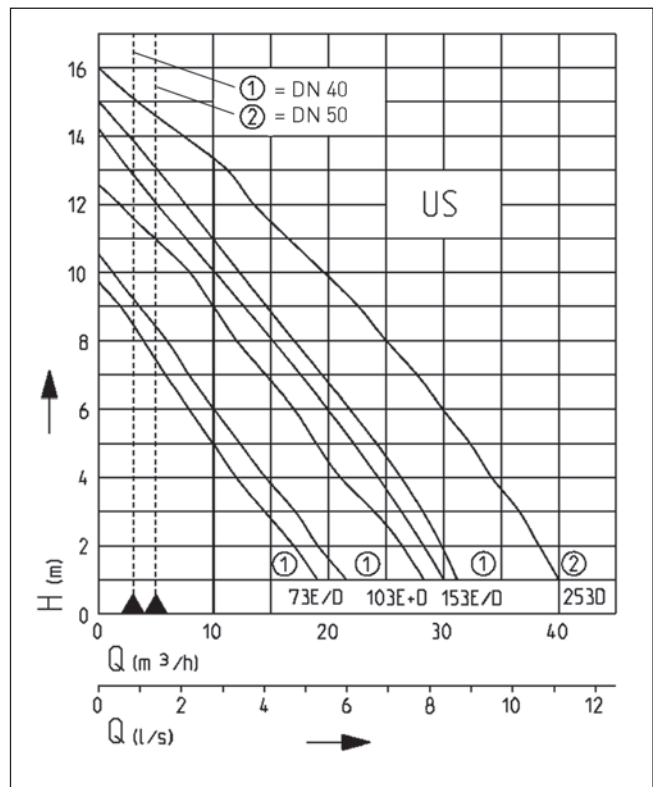

Type	Delivery head H [m]	1	2	3	4	5	6	7	8	9	10	11	12	13	14
US 73 ES	Flow rate Q [m³/h]	19	17	15	12	10	8	6	4	2					
US 103 ES		28	26	23	21	19	17	15	12	10	8	5	2		

Specifications can be changed without notice. Performance subject to ISO 9906 tolerances. This data is represented in the performance curve as a limit of application.

US 73-US 103

SUBMERSIBLE DRAINAGE PUMP

SCOPE OF SUPPLY

Pump ready for connection with 10 m cable. US 73 and US 103 with 3 flat-pin ANZ plug.

MECHANICAL DATA

Pump	Vertical single-stage
Free passage	30 mm
Bearing	Ball bearings, grease-lubricated
Seal on motor side	Duplex rotary shaft seals
Oil chamber	Yes
Seal on medium side	SiC mechanical seal
Run dry protection	Yes

Shaft	Stainless steel
Impeller	Vortex impeller, GFK
Motor housing	Stainless steel
Pump housing	Grey cast iron
Submersible	Yes
Pressure outlet	1 1/2" FI

ELECTRICAL DATA

Power line	10m H07RN-F
Type of enclosure	IP 68

Insulation class	B
Winding thermostat	Yes

US 73-US 103

Type	Code No.	Voltage	Motor rating		Current	Wires	Motor protection	Plug	Free passage	Weight
			P1	P2						
With built-in level control										
US 73 ES	JP47370	1/N/PE~230 V	0.83 kW	0.50 kW	3.9 A	3G1,0	Integrated	ANZ	30 mm	12.5 kg
US 103 ES	JP44237	1/N/PE~230 V	1.37 kW	0.98 kW	6.0 A	3G1,0	Integrated	ANZ	30 mm	14.0 kg

Dimensions and switching points US 73, US 103, US 153 (mm)

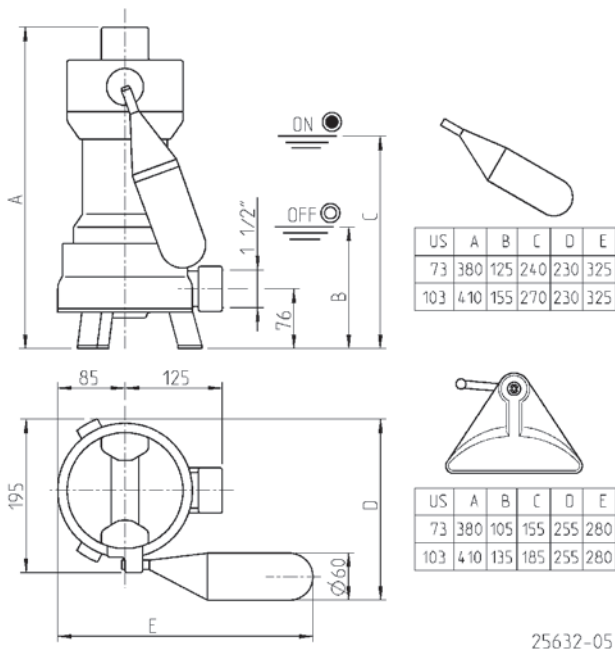

Dimensions and switching points with GR 40 (mm)

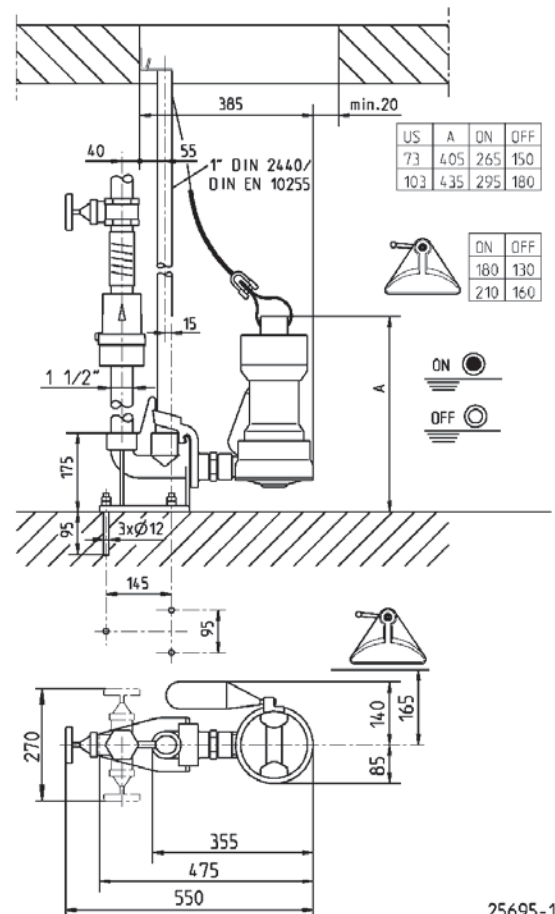

US 73-US 103

SUBMERSIBLE DRAINAGE PUMP

Example of single pump station with GR

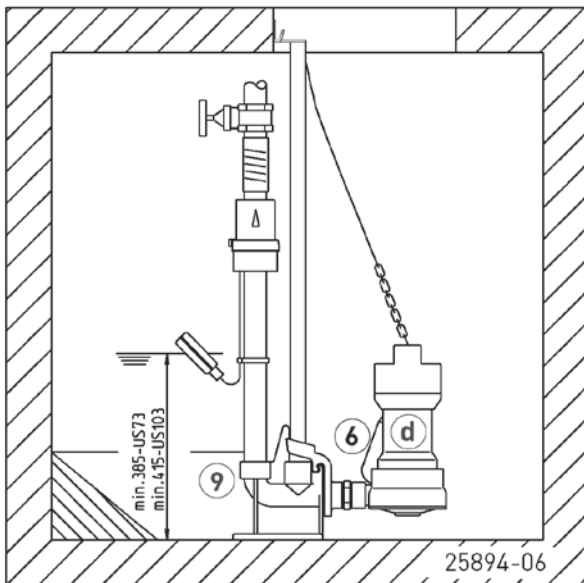

Single unit 1/2" with GR 40: sump area min. 40x60 cm
Single unit 1/2" without GR: sump area min. 40x40 cm

MECHANICAL ACCESSORY

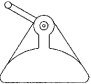
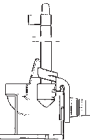
			Code No.
	6 Special float	for lower switching points	JP44795
	9 Guide rail system	GR 40	JP25592